

# MARCO

## SERIES 800

### TERMINAL BLOCKS

# 9/16 CENTER 600 VOLTS 75 AMP



UL RECOGNIZED

CSA APPROVED

## BASE STYLES

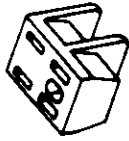

CLOSE BACK



ROUND BASE

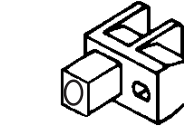
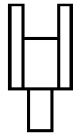

SQUARE NO FINS  
(BARRIERS)

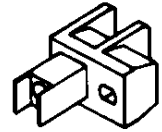

SQUARE WITH  
FINS (BARRIERS)

### Specs.

Construction: Closed Back or Insulated Base (Feed-Thru)

Terminal Centers: 9/16"

Current Rating: 75 Amps

Voltage Rating: 600V

Material: Nylon (Color Back)

Screws: 8/32 Steel Nickel Plate (Available: 8/32 Brass Nickel)

10/32 Steel Nickel Plate (Available: 10/32 Brass Nickel)

# Of Terminals: 1 to 24 Positions

UL Flame Retardant Rating 94V-0

All Type Sems Screws Available

All Stud inserts are brass no plating, Plating available Special Order

Top Hardware Optional see Marco QC series (Quick Connect Tabs)

**CLICK ON 800 PHOTO'S TO VIEW PICTURE OF BLOCKS**

### DIMENSIONS

NUMBER OF TERM	A	B	NUMBER OF TERM	A	B
-02	2.13	1.69	-14	8.88	8.44
-03	2.70	2.25	-15	9.45	9.00
-04	3.26	2.81	-16	10.01	9.56
-05	3.82	3.37	-17	10.57	10.12
-06	4.38	3.94	-18	11.13	10.69
-07	4.95	4.50	-19	11.70	11.25
-08	5.51	5.06	-20	12.26	11.82
-09	6.07	5.62	-21	12.82	12.37
-10	6.63	6.19	-22	13.38	12.94
-11	7.20	6.75	-23	13.95	13.50
-12	7.76	7.31	-24	14.51	14.06
-13	8.32	7.87			

NOTE: A dimensions are approximate

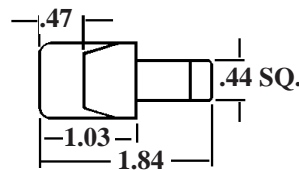
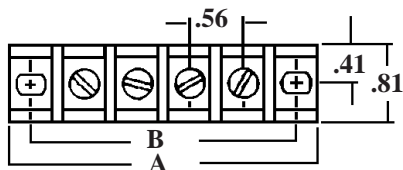

SQUARE BASE

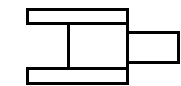

ROUND BASE

### TOP HARDWARE VARIATIONS

- SS ..... = ..... 8/32 SCREW
- SS10 .... = ..... 10/32 SCREW
- ST ..... = ..... 8/32 STUD
- ST10 ... = ..... 10/32 STUD

### BOTTOM HARDWARE VARIATIONS

- NF ..... = ..... NON FEED- THRU
- FS ..... = ..... 8/32 SCREW
- SFTP . = ..... SHORT FEED THRU TAPER PIN (SOLDER)
- LFTP . = ..... LONG FEED THRU TAPER PIN (SOLDER)



OTHER ARE OTHER TOP AND BOTTOM HARDWARE VARIATIONS AVAILABLE,  
CONSULT FACTORY FOR PART NUMBERS.